

## FP200 Finger Protection

Fixing applications - typical UK applications overleaf

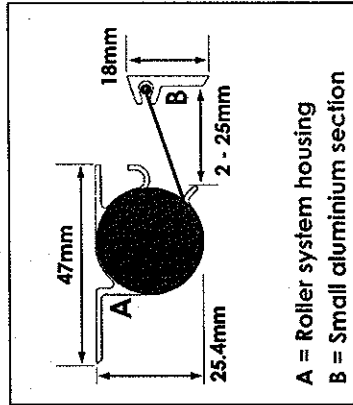

**FP200 roller system dimensions**

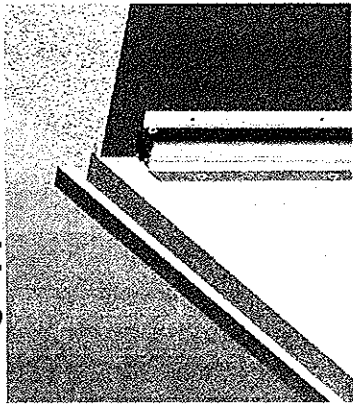

**FP200 roller system mounted on recessed door and frame**

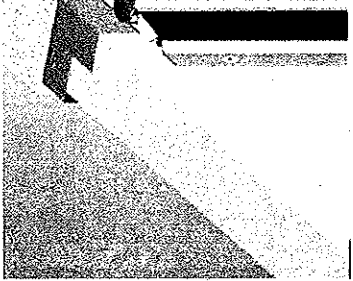

**FP200 roller system mounted on flush door and frame**

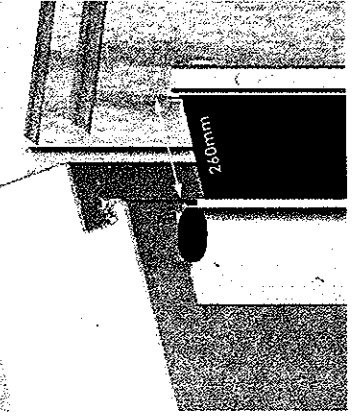

**FP200 roller system maximum opening 260mm**

### Installation instructions

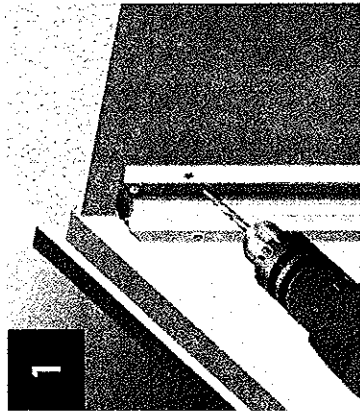

**1 Drill pilot holes for A roller system housing**

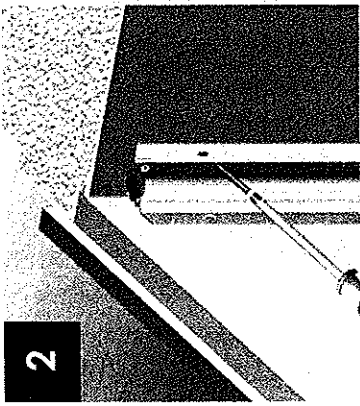

**2 Fix with screws provided**

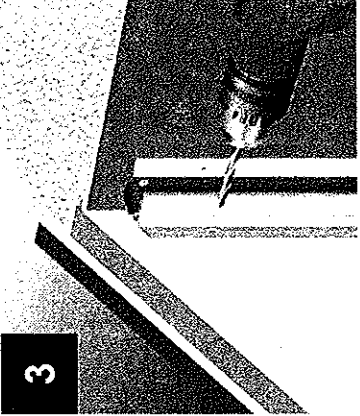

**3 Drill pilot holes for B small aluminium section**

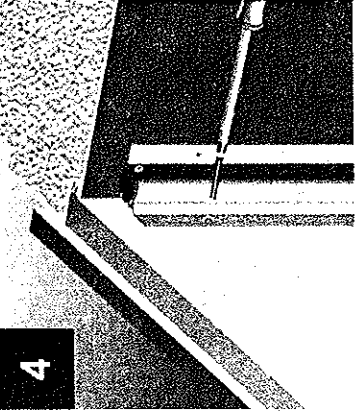

**4 Fix with screws provided**

**FP200 typical applications on door and frame**

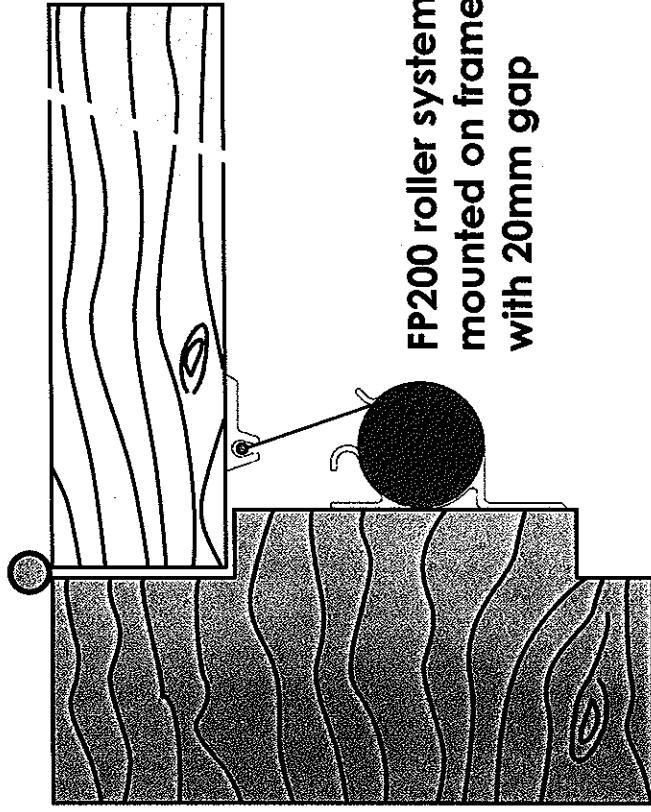

**FP200 roller system  
mounted on frame  
with 20mm gap**

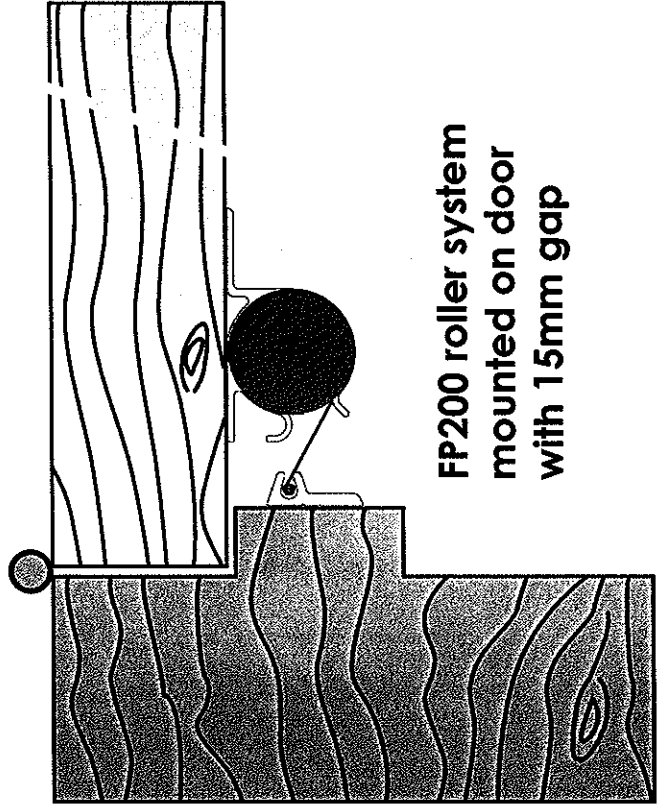

**FP200 roller system  
mounted on door  
with 15mm gap**

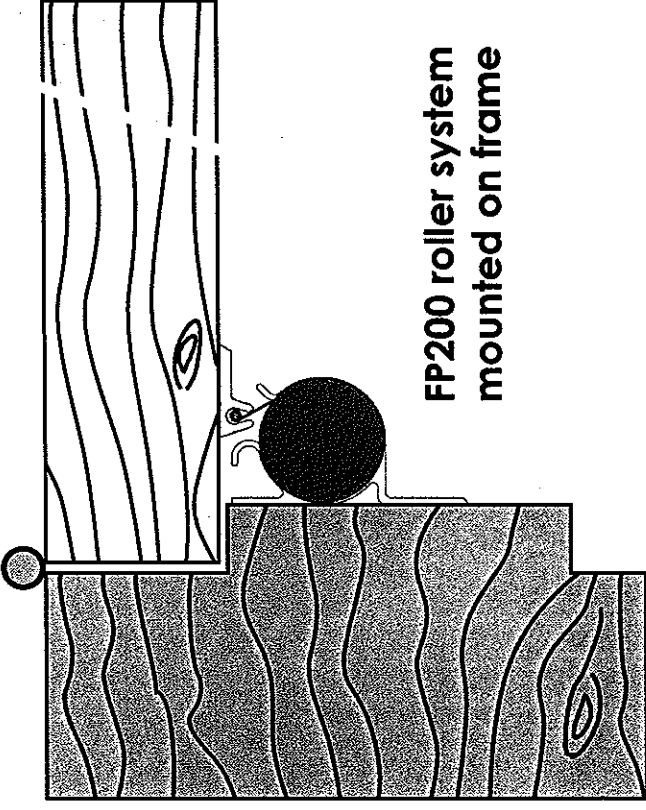

**FP200 roller system  
mounted on frame**

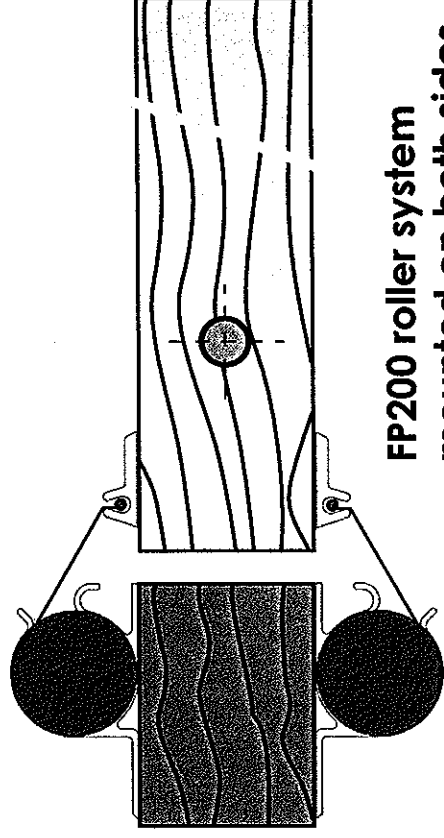

**FP200 roller system  
mounted on both sides  
for centre pivot doors**