

Specification

RECESS MOUNT MAGNETIC CONTACT EMK 28 LSA M8/20

Contact type	: single-pole NO contact
Switching voltage	: max. 40 V DC
Switching current	: max. 500 mA
Contact capacity	: max. 6 W or 6 VA
Transition resistance	: max. 0,15 Ω
Breakdown voltage	: > 250 V
Connecting cable	: LIYY 2 x 0,14 mm ² Cu tinned; suitable for LSA-PLUS Insulation
Outer cable colour	: white or brown
Inner conductor	: white
Contact dimension	: Ø 8 x 32 mm
Cable dimension	: Ø 3,2 mm; (< 10 m authorized by VdS)
Magnet in plastic tube	: Ø 8 x 40 mm AlNiCo 5, axial polarized
Housing material	
Magnetic contact / Magnet	: PBT-GF, A-B-S
Colour	: white or brown
Temperature range	: - 25 °C to + 70 °C
Protection category	: VdS - environmental class IV, IP 67
Housing material flange	: PA6 GF 30

Extent of delivery

- 1 Magnetic contact Ø 8 x 32 mm in recess mount flange EF 8/20 for steel, plastic and antimagnetic metal
- 1 Magnet Ø 8 x 40 mm AlNiCo 5 in recess mount flange EF 8/20M for steel, plastic and antimagnetic metal

Technicale changes without prior notice possible

Installation Instructions

Model: EMK 28 LSA M8/20
VdS-No.: G 191 702 A

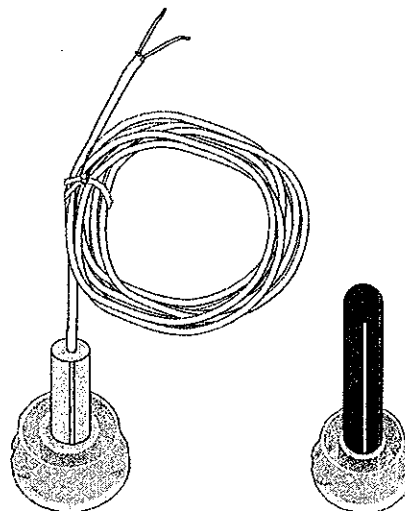

31262800.Y00

448

Description

general notes:

The recess mount flanges EF8/20 and EF8/20M are especially designed for the installation into steel doors. An assembly use in aluminium or plastic windows and doors is possible. Magnetic contact and magnet have to be put to each other in window frames / door leaf and casement frame / door frames on the frontside. Mechanical uses of force e.g. during the assembly on the housing can damage the glass body of the reed contact. The magnet loses a part of its field strength if it gets very hot or through mechanical influences. This also can happen if the magnet is close to the magnetic field of another magnet.

Assembly:

For the EF8/20 set a Ø 20mm hole at the designated position. This is for magnetic contact. For the EF8/20M set a Ø 18 mm hole at the designated position. This is for magnet.
If required, the drilling has to be bured. A straight installation of the recess mount flanges is guaranteed with that.
The recess mount flange has to be put into the designated position non-violently. It is fixed by pushing the flange in the installation place. For this no further tool is required! A hammer should not be used. The claws of the recess mount flange fix it tightly in the assembly place (see the technical specifications as for material thickness of the recess mount material). A subsequent rotation or a correction of the justification is no longer possible after installation.

Only the installer takes the responsibility for a safe functionality and installation of the application in connection with the attached system. Therefore it has to be examined every fall with the technical documents and the composition of the assembly place whether the magnet or magnetic contact fulfils their function.

Caution! In principle, care should be taken that ferromagnetic materials which are nearby the assembly place influence the magnetic field. The switching distances of the magnetic contacts can change.

After completion of the assembly the magnet contact must be checked for its electric switching function (e.g. ohmmeter).

assembly schedule

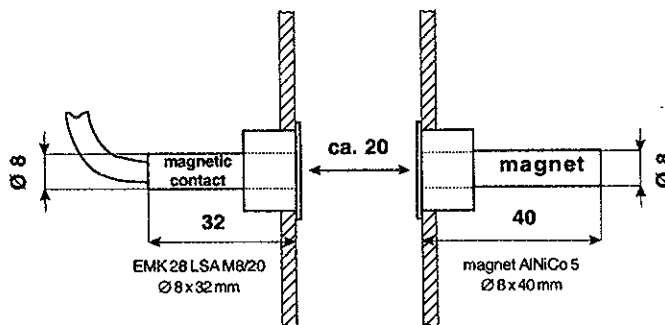

side Mounting displacament: max. ± 3 mm

31262800.Y00

Technicale changes without prior notice possible

Technical details

1. recess mount flange EF 8/20 for magnetic contact

graphic profile:

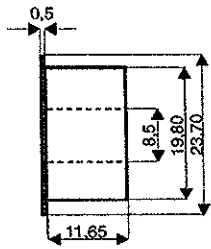

Technicale details:

plastic material: PA6 GF 30
 external diameter without holding clamps : \varnothing 19,80 mm
 lowness flange: 11,65 mm
 allowance material thickness for recess mounting: 0,8 - 2,3 mm
 drilling for recess mount flange: \varnothing 20,00 mm

2. recess mount flange EF 8/20M for magnet

graphic profile:

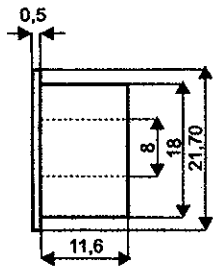

Technicale details:

plastic material: PA6 GF 30
 external diameter without holding clamps : \varnothing 17,80 mm
 Tiefe Flansch: 11,60 mm
 allowance material thickness for recess mounting: 0,8 - 2,3 mm
 drilling for recess mount flange: \varnothing 18,00 mm

schematic diagram

schematic of distance

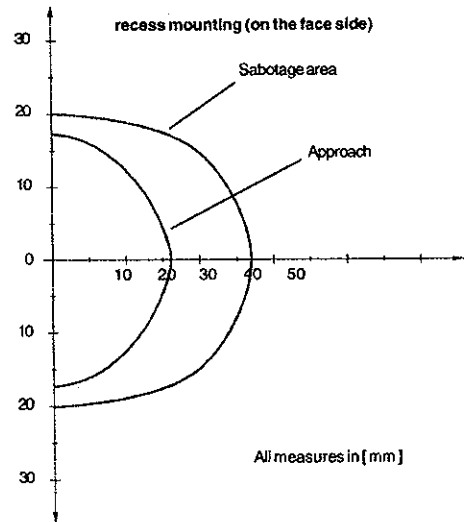

connecting cable:

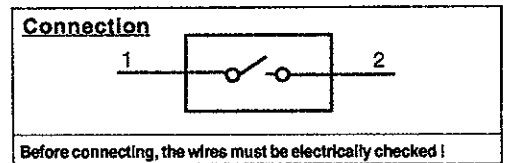
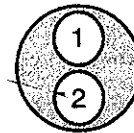

31262800.Y00

Technicale changes without prior notice possible