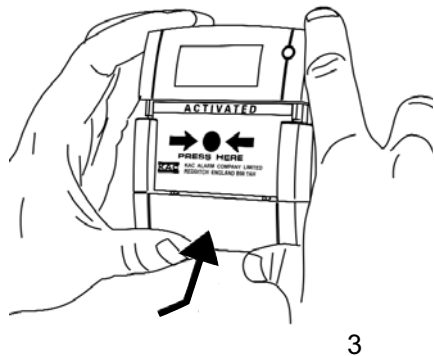
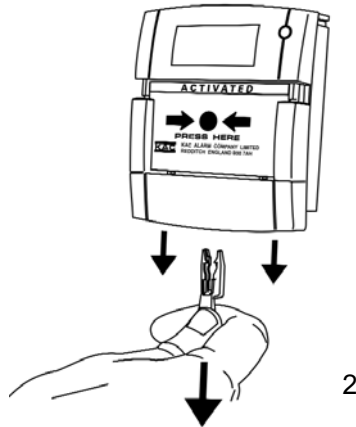
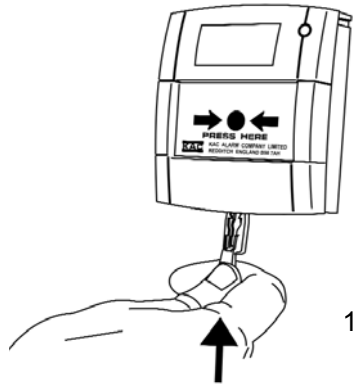
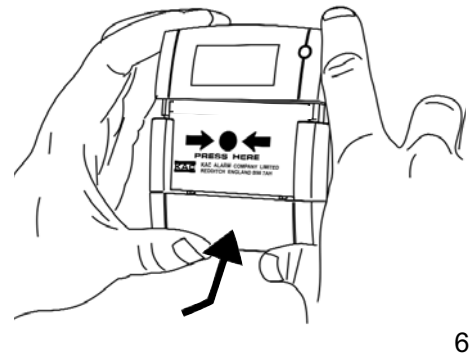
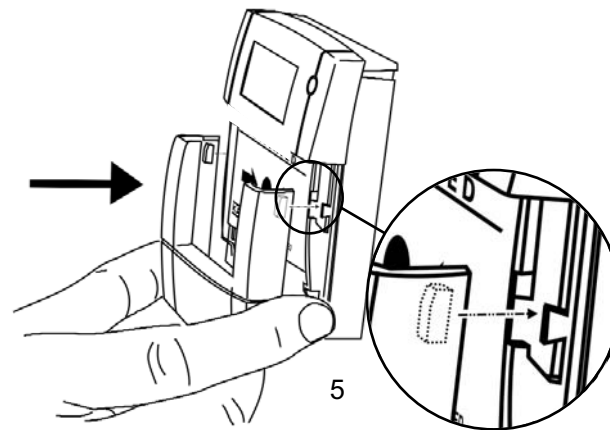
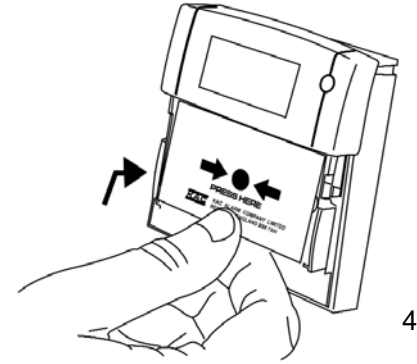
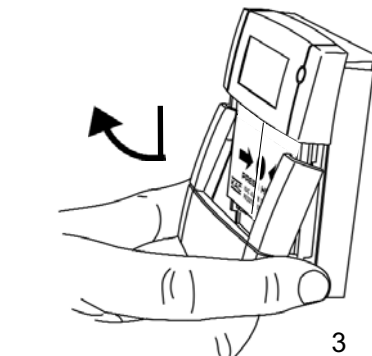
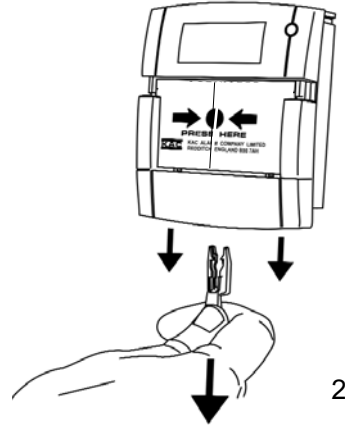
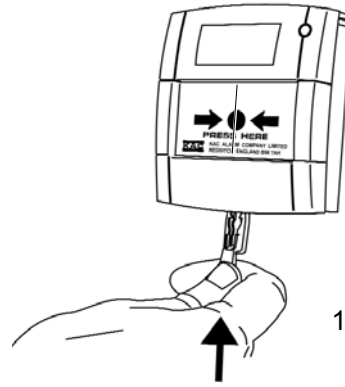
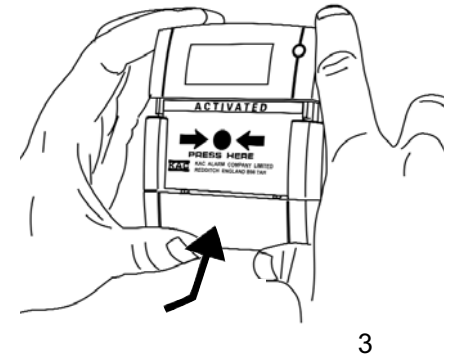
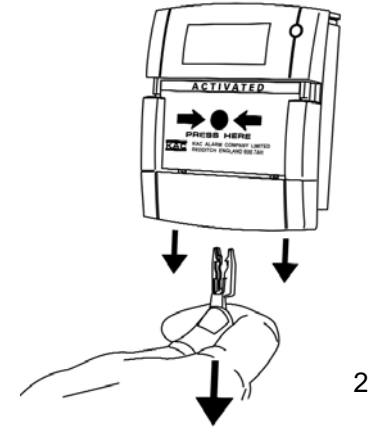
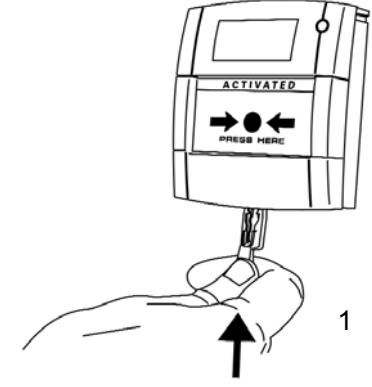

TO TEST**TO REPLACE GLASS / RESETTABLE ELEMENT****TO RESET**

CONNECTION DETAILS	MUS1A-X	MUS1B-X	MUS2A-X	MUS2B-X
<p>OR</p>				

X in the MUS code (left) represents the final digits of the part number, which indicate MUS colour, component values, mounting options and element type.

eg MUS1A -R470SF
 II
 (MUS1A, Red, 470R, Surface, Flexible Element).

DIMENSIONS

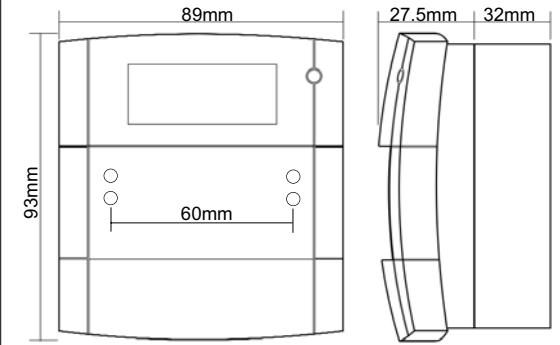

PUSH FIT CONNECTOR

After wiring the terminal connector, plug into the appropriate position, see connection details (left).

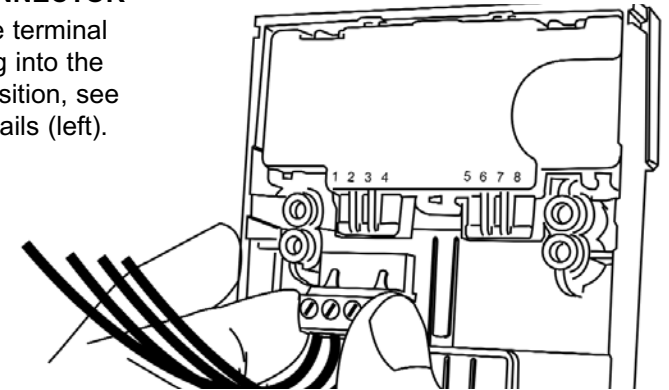

CONNECTION DETAILS	MUS3A-X	CONNECTION DETAILS	MUS4A-X
<p>OR</p>		<p>OR</p>	

TECHNICAL DATA

30VDC Max

2A Max

IP24D

110/160g

-10°C to 55°C



Red, Ral 3001
 Yellow, Ral 1006
 Green, Ral 6016
 White, Ral 9010
 Blue, Ral 5002



Important Notes; -
Please do not over tighten fixing screws.
The use of lubricants, cleaning solvents or petroleum based products should be avoided.